

# NATURAL ENGLISH THEME - NATIONAL FINAL ADVANCE

## Materials:

Paving: Fairstone Antique Paving Autumn Bronze Multi, 560 x 275 x 22 mm. Laid in courses, with 50% offset (as shown on detail)  
10mm Mortar Gap

## Turf:

Area in front of seating to be General Grass turf.

Four 550 x 560mm square sections set into paving are to be Wild Flower turf.

Walling: Fairstone Tumbled Autumn Bronze, 220 x 100 x 65mm

To be laid Stretcher Bond, 10mm mortar, with Raked Out joints to provide Dry Stone Walling effect

Coping to Wall: Fairstone Antique Autumn Bronze Multi, to use 702 x 560 x 22mm, but to cut to size where required. Maximum 5mm Mortar joint. Coping for raised tree planting bed to be Fairstone Antique Autumn Bronze Multi 560 x 275 x 22. No overhang to coping, flush with walling

Pergola: to be softwood 2.2m high. 1280mm between posts.

Fencing: timber fencing panels to be 1800x1500mm with 100x100mm posts.

## Water Feature:

Stainless Steel Water Chute located on end of bench, (as shown on detail) with underground plastic reservoir and pump for water to be caught and recirculated.

Dry Riverbed to be laid with Atlantic Cobbles 120mm up to edge of planting  
To be edged with Steel Ever Edge to retain cobbles on both lengths

Frame: Softwood Timber Planks, 30mm x 100mm x lengths to suit

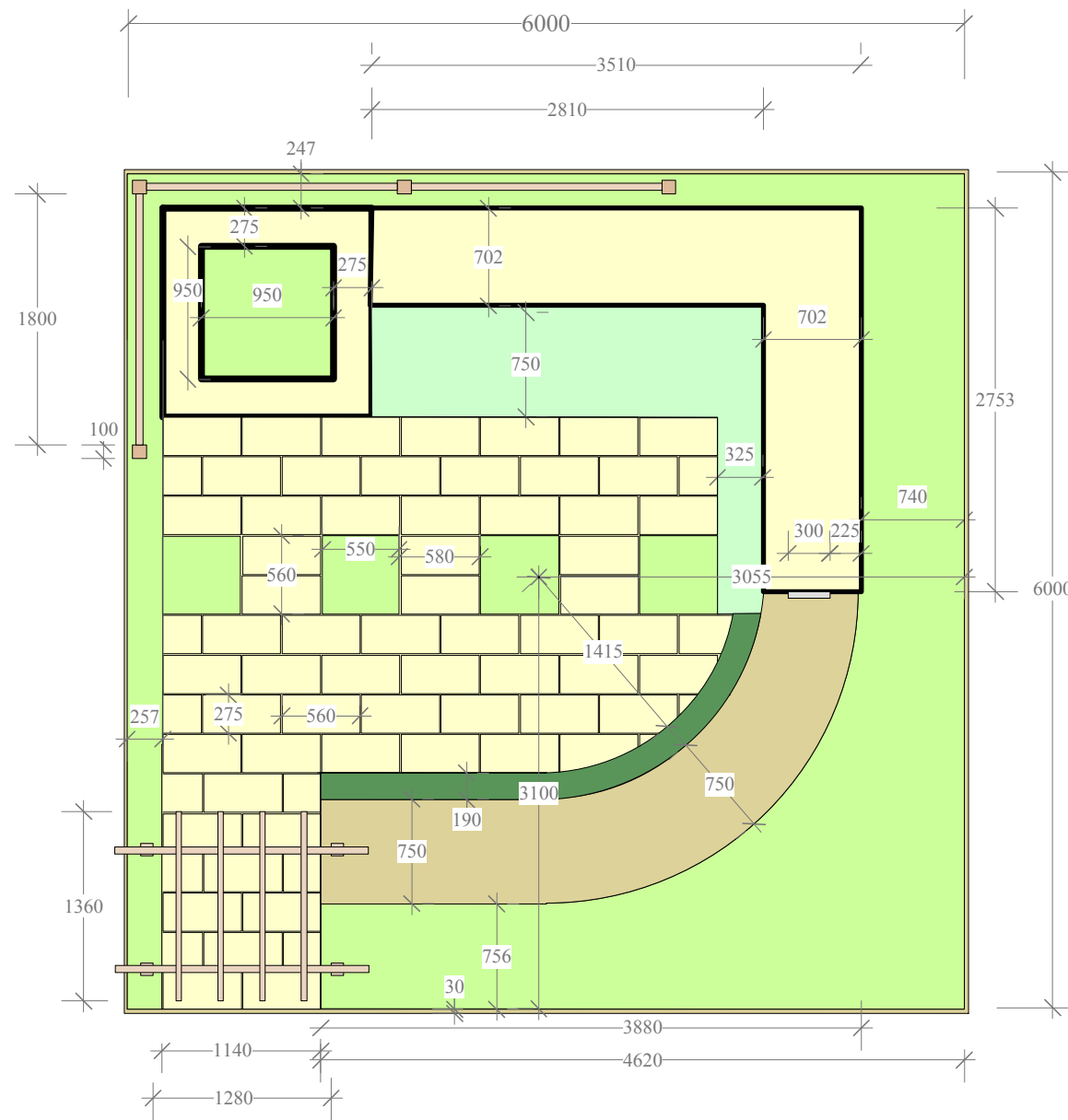

Elevation View - Raised Planting Bed and Seat  
Scale 1:25

Plan View - Raised Planting Bed and Seat

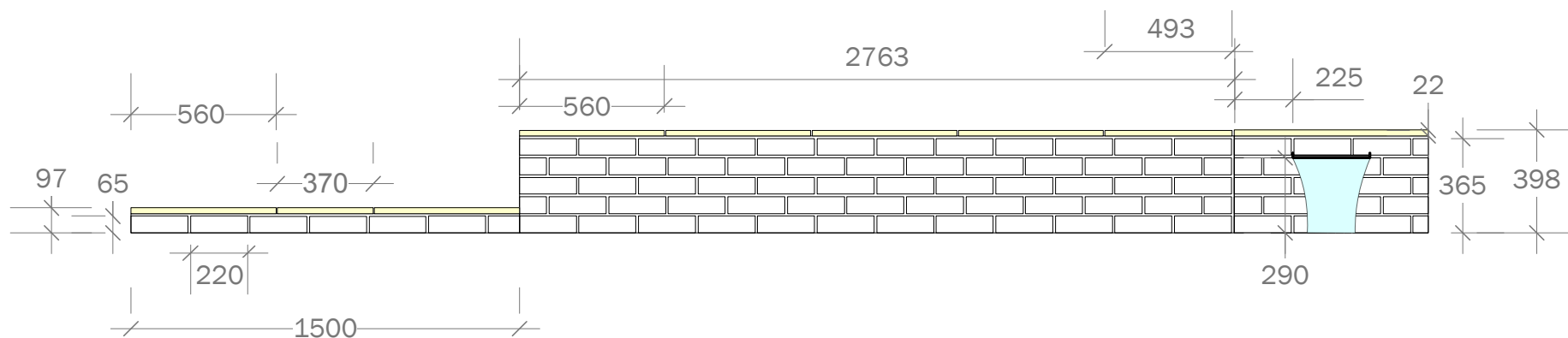
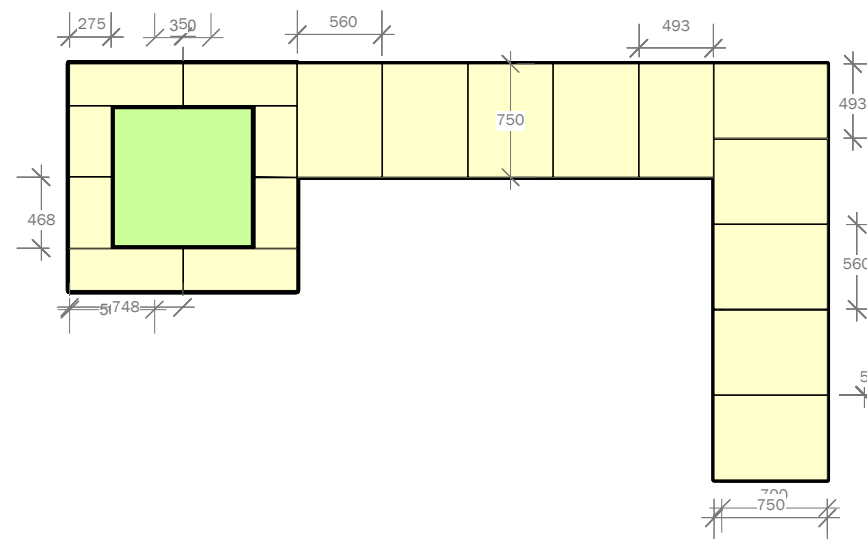

Sheer Decent Water Blade; Mounted behind brick wall



YOUR CONTACT	Patricia Fox		
TELEPHONE NUMBER	01279 730 040		
DRAWING REFERENCE	Plan View with Dimensions & Materials		
DATE	1.2.10		
CLIENT	BALI / UK World Skills		
SITE	National Heat / Malvern		
DETAIL	Presentation Plan		
SCALE	1:50	VERSION	1